

South Face of Upper Barn

UniRac SolarMount PV Standard Rail Flush Mount

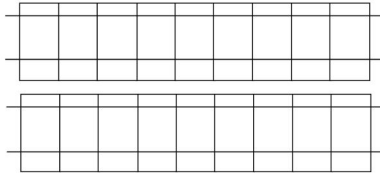

2 rows of 9 modules mounted on 4 rails running across the roof horizontally. UniRac hanger bolts through roofing with a minimum of 2" of threads into rafters. 6' maximum horizontal bolt spacing.

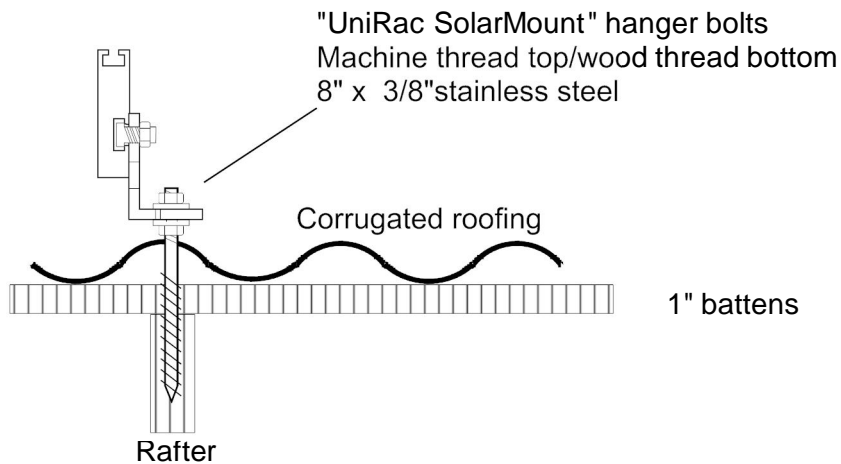
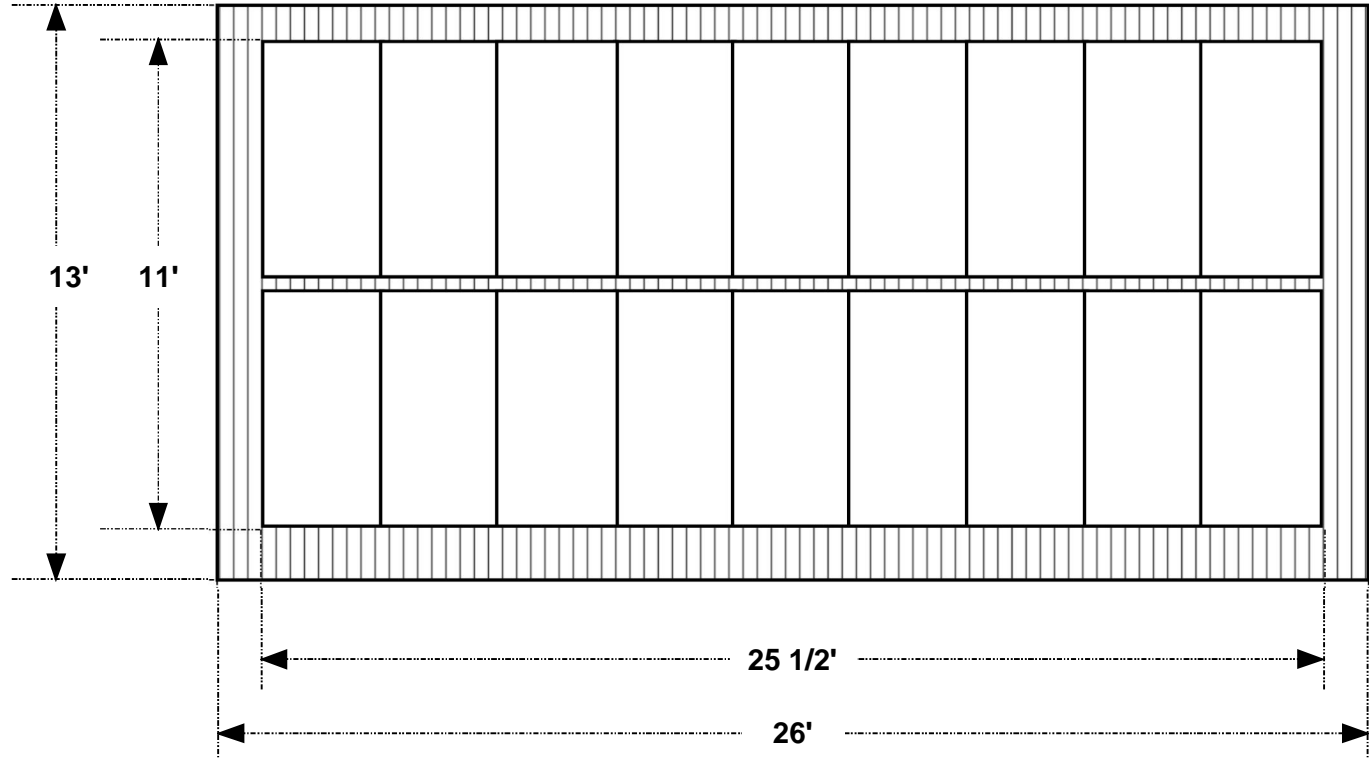

18 Mitsubishi PV-UD180MF5 180 watt
Solar Modules weigh 37 lbs each = 666 lbs
rails with hardware weigh approx. 150 lbs.
Array Area = 280.5 sqft
 $816 \text{ lbs} / 280.5' = 2.91 \text{ lbs/sqft}$

See UniRac.com "SolarMount" for more details.

Title: PV Module mounting details for upper barn	
Author: Alex Aragon	
Date: Jan 24, 2008	Sheet:
Revision:	