

Commander 4500 Series Removal and Installation

Commander 4500 Series Console Control Removal

1. Remove the two screws securing the remote control cover to the base assembly. Lift the remote control cover off of the base assembly.

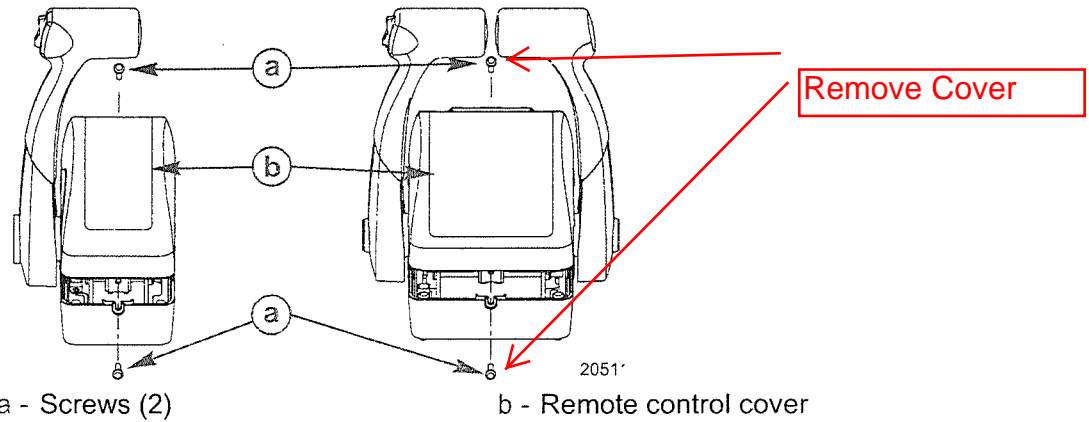

2. Cut the cable tie securing the trim switch wire harness to the cable tie anchor.
3. Remove the four screws securing the remote control module assembly to the console.

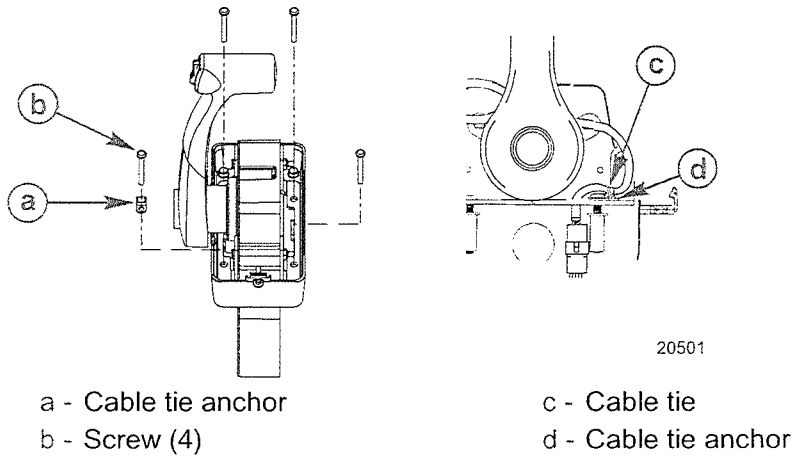

4. Disconnect the control handle trim switch wire harness connector.
5. Disconnect the remote control cover trim switch wire harness connector if equipped.

- Connect the remote control module assembly neutral start safety switch leads to the wire harness. Apply Liquid Neoprene to the connection to prevent corrosion. Allow the Liquid Neoprene to dry. Protect each connection with a rubber sleeve or shrink tubing.

▲ WARNING

Avoid serious injury or death from a sudden unexpected acceleration when starting the engine. The neutral start safety switch must be correctly connected to prevent engine startup when in gear. Refer to wiring diagrams for correct wiring connections.

NOTE: Some remote control models have bullet connectors instead of ring terminals.

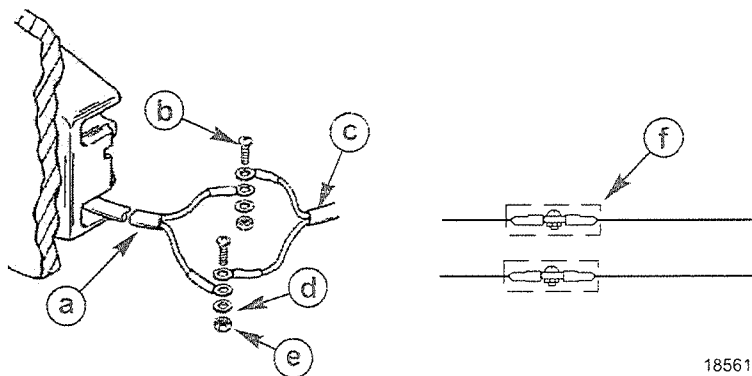

- a - Control module neutral start safety switch wire harness
- b - Screw (2)
- c - Boat wire harness
- d - Washer
- e - Nut
- f - Rubber sleeve

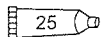
Tube Ref No.	Description	Where Used	Part No.
 25	Liquid Neoprene	Neutral start safety switch wire connection	92-25711-3

5. Adjust the control friction to the desired resistance.

- Turn the control friction adjustment nut clockwise to increase the resistance.
- Turn the control friction adjustment nut counterclockwise to decrease the resistance.

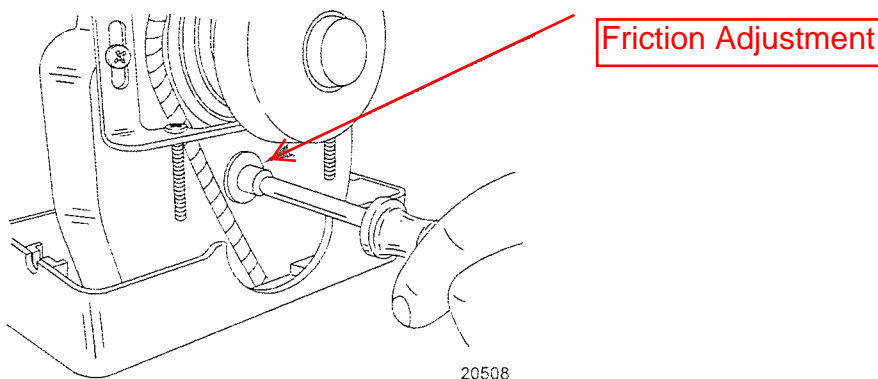

- Connect the trim switch harness connector to the wire harness connector. Ensure the trim switch harness wires are at the rear of the remote control module assembly.